

# New from Cuddeback... the CuddeView 4-in-1 Field Viewer

CuddeView is the ONLY device you need to view, transfer and delete your digital scouting camera images.

## 1. View images in the field -

Use CuddeView to view your images in the field. CuddeView serves as a PC or laptop card reader, so you can download images to your computer (cable included; requires USB port and Windows XP/Vista operating system).

## 3. View images on your TV -

CuddeView comes with a TV cable so you can see your scouting camera images on your TV (TV requires RCA video-in port).

## 4. Transfer images -

Eliminate card swapping! Check each scouting camera and, using CuddeView, transfer images from each camera's CF/SD card to a single high-capacity (we recommend 2.0GB) SD/CF "archive" card.

- Compatible with CompactFlash and SD cards
- View, transfer and delete images
- Built-in rechargeable lithium battery
- Built-in LED light



Non Typical, Inc. • 860 Park Lane • Park Falls, WI 54552  
715-762-2260 • Fx: 715-762-2719  
www.cuddebackdigital.com  
Rev 2

This device complies with Part 15 of the FCC Rules. Operation is subject to the following two conditions:  
(1) This device may not cause harmful interference, and  
(2) This device must accept any interference that may cause undesired operation.

Fast trigger speed,  
long battery life



5 MINUTES  
is all it takes to  
master the Capture

Operating Instructions  
**Capture**

## Introduction

Thank you for purchasing a Cuddeback Capture digital scouting camera. Capture is so easy to use that you may feel you do not need to read this manual. However, we recommend you spend 5 minutes reading this manual to familiarize yourself with the not-so-obvious features of the Capture. At the very least, read on how to check your Capture.

## What You Need

Before you can use your Capture, you will need the following items:

1. One or more Secure Digital (SD) cards. We recommend sizes up to 2 GB, with 1 GB being the preferred size. The higher the number on the card, the more images that can be saved on the card. DO NOT USE SDHC CARDS.
2. Four D Cell batteries (we recommend Rayovac, Duracell or Energizer brand batteries).
3. An optional padlock if you want to prevent tampering. The shaft of the padlock must be ¼ inch or smaller to fit through the Capture's padlock opening.



## STEP 1 – Familiarize Yourself with Capture

Take a moment to familiarize yourself with Capture's parts.

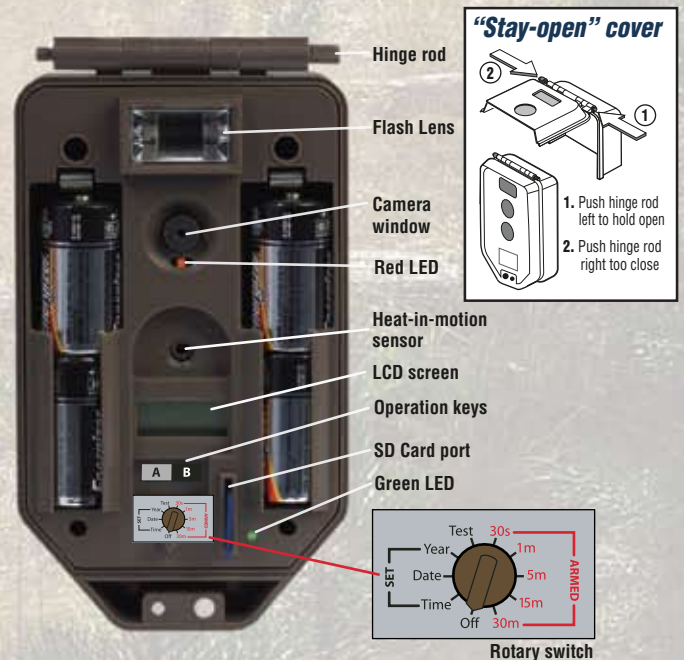

## STEP 2 – Turning Capture On

1. Mount the supplied tree bracket to the back of the camera with the supplied screw.
2. Turn the rotary switch to the OFF position.
3. Install 4 new alkaline D cell batteries. Make sure to observe correct polarity.
4. A series of numbers will be displayed. These are the Capture's hardware and software version numbers.
5. Wait until the LCD display goes blank and the green & red LEDs turn off.
6. Install SD card. We recommend a 1 GB size card.

### **STEP 3 – Setting up the Capture**

Turn the rotary switch to **Time** position, press A to set hour and B to set minutes. Time is AM/PM format.

Turn the rotary switch to **Date** position, press A to set month and B to set day.

Turn the rotary switch to **Year** position, press A to go back and B to go forward.

### **STEP 4 – Attaching Capture to a Tree**

Attach Capture to a tree with the supplied strap. For optimum detection of “deer size” animals we recommend mounting the Capture about 3 feet from the ground. For best image quality, install Capture about 10 to 15 feet from the area animals are expected. However, the Capture will detect animals at distances from directly in front of the camera to about 50 feet. Note that detection distance varies greatly with air temperature, subject size and movement speed.

It is best to remove any vegetation and obstructions from the Capture’s field of view as they may interfere with the Capture’s sensor or camera.

Aim/align the Capture to make sure it is pointed where you expect the animals to be. You can use the Capture’s Test feature, as explained next, to help you determine the detection zone.

### **STEP 5 – Checking the Capture’s Detection Zone**

Turn the rotary switch to the Test position. Close the cover and tighten the thumb screw. Walk back and forth in front of Capture. The red LED will illuminate when the Capture’s sensor has detected you. Using this method you can accurately position your Capture as desired.

### **STEP 6 – Arming the Capture**

Turn the rotary switch to one of five Armed delay settings. These settings represent the amount of time the Capture will wait before it will take another image. This dwell time prevents multiple images of the same animal.

- 30 seconds – best setting for game trails
- 1 minute – use on scrapes
- 5 minutes – food plots or feed stations
- 15 minutes – feed stations
- 30 minutes – feed stations

When first armed, the Capture will display the indicated delay for 5 seconds and then begin counting down from 40 to 0. When the counter gets to 0 the Capture will arm and be ready to record images. This gives you time to leave the area. Once the Capture takes a picture, the LCD will display the delay setting and begin counting down. Once the counter reaches “0” the Capture is ready to record the next image.

### **STEP 7 – Checking Capture**

Note - When you approach the Capture it will probably take a picture of you. This should not be a concern as the image can be deleted later. Open the cover and the LCD display will probably be counting down as the Capture will be in the delay or dwell time after taking your photo.

Press the A or B switch to temporarily suspend the Armed mode. The number of images on the SD card will be displayed. Press the A or B switch again to view additional information. Here is the sequence of data that is displayed each time the A or B key is pressed.

- a. Images on SD card. (Note the ARMED, DWELL, & IMAGES icons are displayed.)
- b. Free Space on SD card in MB. (Note that ARMED & DWELL icons are displayed.)
- c. Time
- d. Date
- e. Year
- f. - -, dashes indicate the Capture is in Test mode and will illuminate the red LED when activity is seen. Capture will automatically [auto arm] in about 4 minutes. This allows you to close the cover and leave the area.

Pressing the A or B switch again will auto arm the Capture.

### **STEP 8 – Viewing Images**

Once you have the Capture in one of these states (a thru f - see step 7) remove the SD card.

**Do not remove the SD card if the green LED is illuminated.**

There are three ways to view images. **First**, you can view the images with an optional viewer or a point-and-shoot camera that is able to read Capture images (NOTE: not all SD-based cameras can view Capture images, please test any camera before purchasing).

**Second**, replace the SD card with a fresh SD card and take the original SD card with you to view on your PC or other device.

**Third**, Cuddeback’s CuddeView 4-in-1 viewer will allow you to view the images, copy the images to a CF card, erase the images from the SD card, and then put the original SD card back into Capture. CuddeView allows you to use one CF card to record images from multiple cameras. See [www.cuddebackdigital.com](http://www.cuddebackdigital.com) for more information on CuddeView.

### **Using Capture without SD Card**

When Capture is used without an SD card, images are stored in Capture’s internal image memory. Capture features an internal memory of about 30 MB. This may allow storage of up to 100 images. Images can be transferred from internal memory to an SD card.

If you use the Capture without an SD card, follow these steps to transfer the images from the internal memory to an SD card.

1. Turn the rotary switch to OFF, and wait until the LCD goes blank.
2. Wait until the green LED turns off and then install an SD card.
3. Turn the rotary switch to any other setting, such as Set Time.  
The green LED will turn on.
4. When the green LED turns off (NOTE: You may need to wait up to 3 minutes) the images have been copied from the internal memory to the SD card.

**DO NOT REMOVE or INSTALL the SD CARD WHEN THE GREEN LED IS ON.**

### **Battery Life & Low Battery Warning**

The life of the batteries in your Capture will vary depending upon battery quality, ambient temperature, and the number of images taken. Our testing shows that Capture will take over 2,000 images on a single set of batteries (at room temperature). You may get more or less than 2,000 depending on your circumstances. We strongly recommend you use Rayovac, Duracell, or Energizer brand batteries.

Replace Capture batteries when 1) “B LOW” appears on the LCD screen (which stands for batteries low) or 2) Capture does not appear to operate correctly (in some cases the batteries may be too low to even turn on the B LOW icon).

### **Use your Windows PC to manage Cuddeback images with Trophy Room Image Management Software**

**Trophy Room** Image Management Software will revolutionize scouting camera image management and how you use your images to make you a better hunter.

Trophy Room is a full-featured PC program that:

- Automatically copies images from your SD or CF card to your PC. It even erases the card when finished.
- Organizes your images by the year and date they were copied to your PC.
- Allows you to rename each folder to make it easy to find your images.
- Displays sun and moon data for each image, including moon phase, moon rise & set, sunrise & set, and even moon and sun position in the sky at the time the image was taken.
- Categorizes images as buck, doe, fawn, bear, etc. There are 28 categories to select from. For whitetail deer, you can enter point count and give the deer a name to allow easy monitoring of trophy animals.
- Automatically calculates the buck/doe/fawn ratios based upon your images.
- With the **CuddeCharts** feature you can analyze your images to determine peak movement patterns based upon sun and moon phase and position.
- With the **Crystal Ball** feature, you can use the data you collected and analyzed with CuddeCharts to predict future activity. Think of this as the traditional moon tables, only much better and tailored to you.

Best of all, **Trophy Room** is free and works with all Cuddeback cameras. You can get it at [www.cuddebackdigital.com](http://www.cuddebackdigital.com).